

NOTES:
 NO SURVEY DATA WAS COLLECTED IN THE PREPARATION OF THESE PLANS. INFORMATION USED TO PREPARE THESE PLANS WAS GATHERED FROM THE FOLLOWING SOURCES, EXISTING DATABASE DATA, CLIENT INFORMATION, INTERNET OR GOVERNMENT WEBSITE DATA.

FOR PERMITTING ONLY - THIS DOCUMENT IS NOT TO BE USED FOR CONSTRUCTION, BIDDING, RECORDATION, CONVEYANCE OR SALES.

THIS DRAWING MY NOT REPRESENT ALL HAZARDS IN THE PROJECT AREA.

PIPELINE AS BUILT INFORMATION AND POSITION TAKEN FROM REFERENCE MAP TITLED "AS-BUILT 24" NATURAL GAS PIPELINE", CERTIFIED BY RUSSELL J. JUDAH, DATED: 6/4/1980.

DRAWN BY:	AZB	APPROVED BY:	ADM
DATE:	6/10/21	JOB NO:	2021.0478
DRAWING NAME:	210478_C1.DWG		
SHEET NO:	1	OF	3
PROJECTION:	TEXAS SOUTH CENTRAL ZONE		
GEO. DATUM:	NAD83 (2011) VERT. DATUM: NAVD88		
GRID UNITS:	US SURVEY FEET		

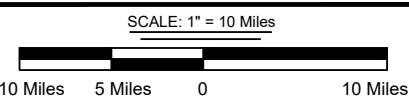

VICINITY MAP			
TRANSCONTINENTAL GAS PIPELINE COMPANY, LLC			
PROPOSED 24" PIPELINE (TO BE DECOMMISSIONED IN PLACE)			
BLOCKS 154, 155, 178 & 179			
PRELIMINARY	HIGH ISLAND AREA FEDERAL WATERS GULF OF MEXICO		
	T. BAKER SMITH A CENTURY OF SOLUTIONS 12825 Trinity Drive, Stafford, TX 77477 (281)240-8113 - tbsmith.com TX. REG. # 181102-61		REV. NO: 00 REV. DATE: --/-- REVISION DESCRIPTION: --

6/22/2021 - P:\Y-2021\2021.0478\DWG\COE\210478_C1.DWG

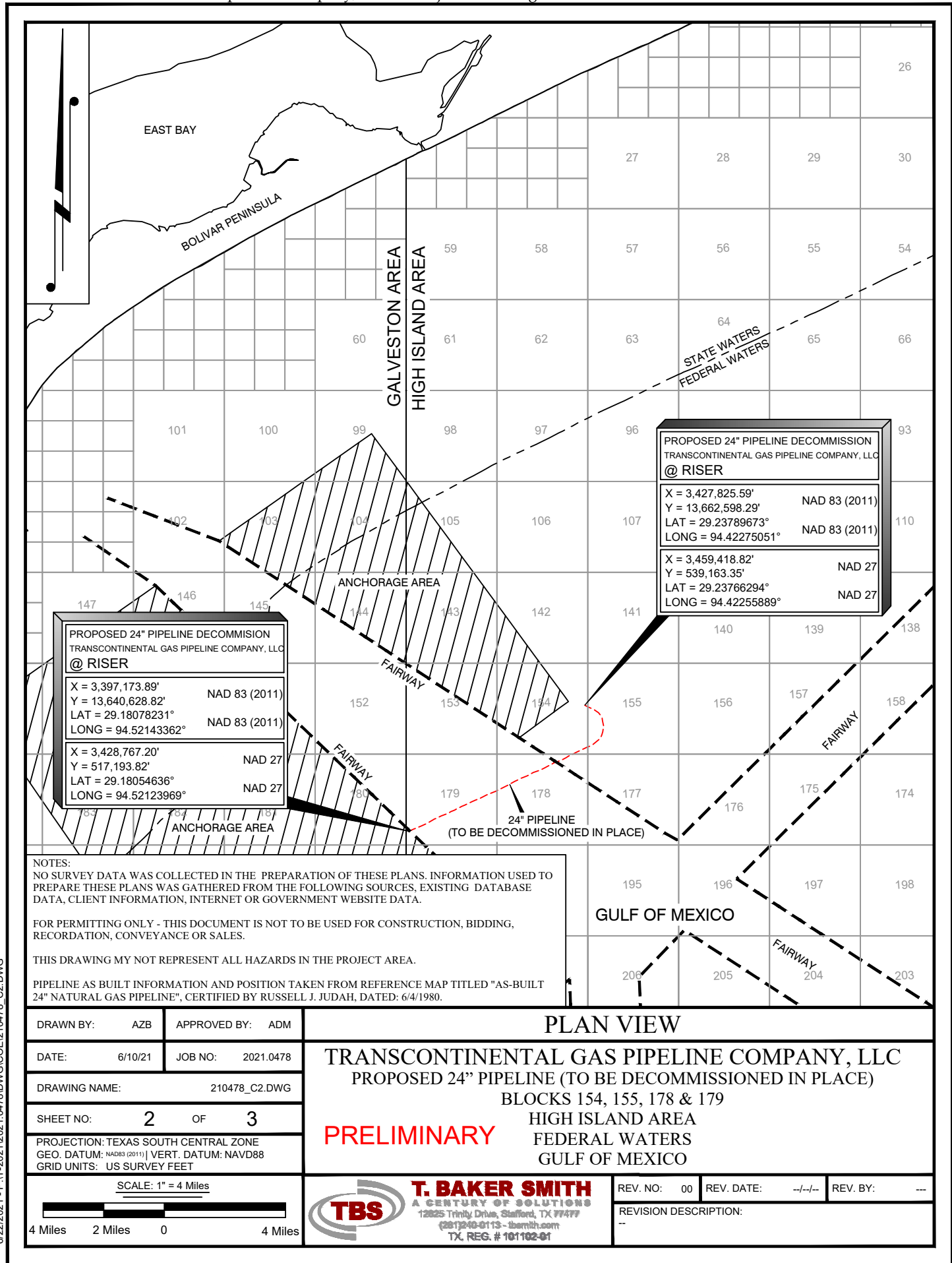

PROPOSED 24" PIPELINE DECOMMISSION
 TRANSCONTINENTAL GAS PIPELINE COMPANY, LLC
@ RISER

X = 3,397,173.89' NAD 83 (2011)
 Y = 13,640,628.82' NAD 83 (2011)
 LAT = 29.18078231° NAD 83 (2011)
 LONG = 94.52143362° NAD 83 (2011)

X = 3,428,767.20' NAD 27
 Y = 517,193.82' NAD 27
 LAT = 29.18054636° NAD 27
 LONG = 94.52123969° NAD 27

PROPOSED 24" PIPELINE DECOMMISSION
 TRANSCONTINENTAL GAS PIPELINE COMPANY, LLC
@ RISER

X = 3,427,825.59' NAD 83 (2011)
 Y = 13,662,598.29' NAD 83 (2011)
 LAT = 29.23789673° NAD 83 (2011)
 LONG = 94.42275051° NAD 83 (2011)

X = 3,459,418.82' NAD 27
 Y = 539,163.35' NAD 27
 LAT = 29.23766294° NAD 27
 LONG = 94.42255889° NAD 27

NOTES:
 NO SURVEY DATA WAS COLLECTED IN THE PREPARATION OF THESE PLANS. INFORMATION USED TO PREPARE THESE PLANS WAS GATHERED FROM THE FOLLOWING SOURCES, EXISTING DATABASE DATA, CLIENT INFORMATION, INTERNET OR GOVERNMENT WEBSITE DATA.

FOR PERMITTING ONLY - THIS DOCUMENT IS NOT TO BE USED FOR CONSTRUCTION, BIDDING, RECORDATION, CONVEYANCE OR SALES.

THIS DRAWING MY NOT REPRESENT ALL HAZARDS IN THE PROJECT AREA.

PIPELINE AS BUILT INFORMATION AND POSITION TAKEN FROM REFERENCE MAP TITLED "AS-BUILT 24" NATURAL GAS PIPELINE", CERTIFIED BY RUSSELL J. JUDAH, DATED: 6/4/1980.

DRAWN BY:	AZB	APPROVED BY:	ADM
DATE:	6/10/21	JOB NO:	2021.0478
DRAWING NAME:	210478_C2.DWG		
SHEET NO:	2	OF	3
PROJECTION:	TEXAS SOUTH CENTRAL ZONE		
GEO. DATUM:	NAD83 (2011) VERT. DATUM: NAVD88		
GRID UNITS:	US SURVEY FEET		
SCALE: 1" = 4 Miles			
4 Miles	2 Miles	0	4 Miles

PLAN VIEW

TRANSCONTINENTAL GAS PIPELINE COMPANY, LLC
 PROPOSED 24" PIPELINE (TO BE DECOMMISSIONED IN PLACE)
 BLOCKS 154, 155, 178 & 179
 HIGH ISLAND AREA
 FEDERAL WATERS
 GULF OF MEXICO

PRELIMINARY

REV. NO:	00	REV. DATE:	--/--	REV. BY:	---
REVISION DESCRIPTION:					

T. BAKER SMITH
 A CENTURY OF SOLUTIONS
 12825 Trinity Drive, Stafford, TX 77477
 (281)240-0113 - tbsmith.com
 TX. REG. # 101102-01

6/22/2021 - P:\Y-2021\2021.0478\DWG\COE\210478_C2.DWG

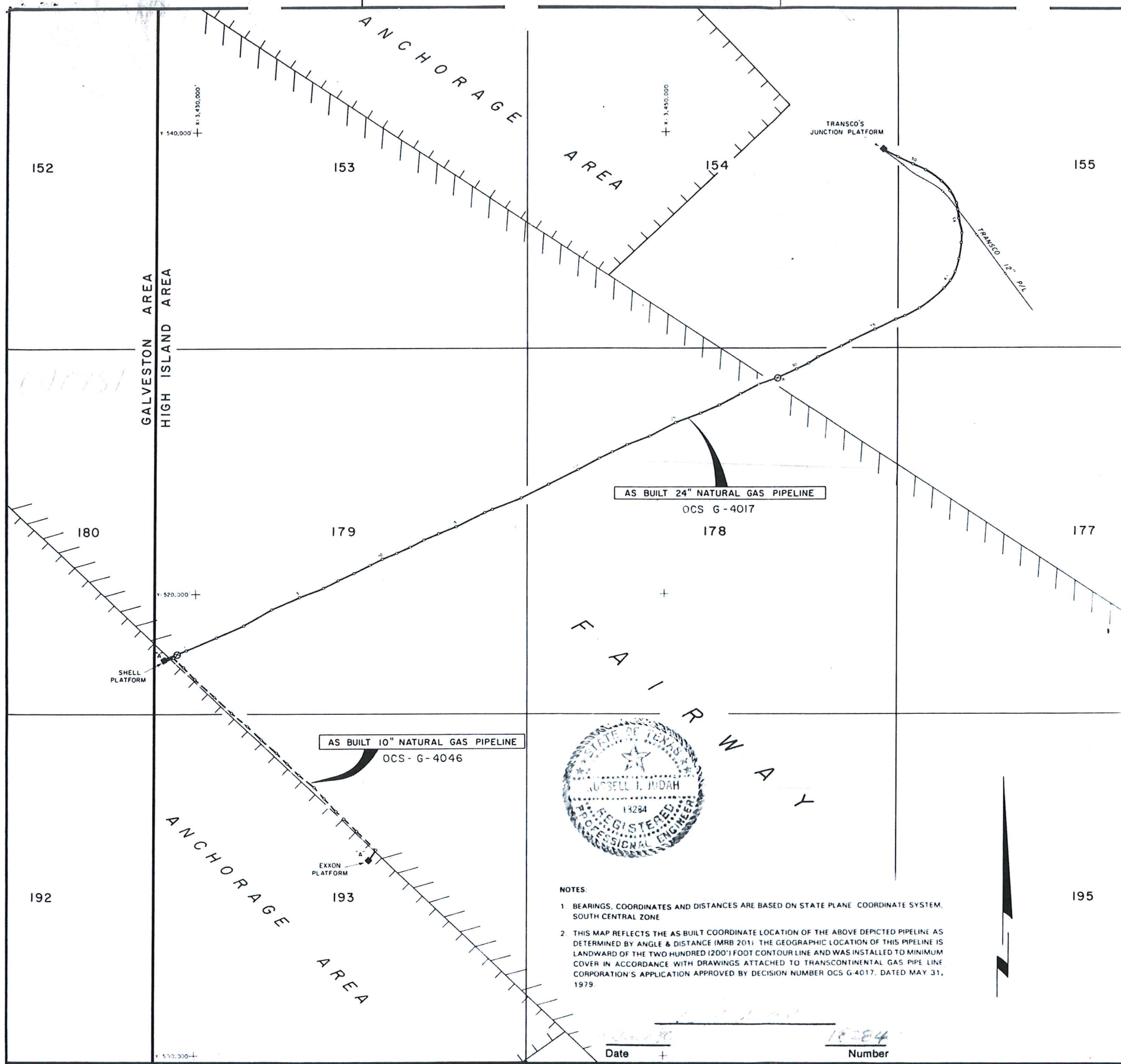

PT.	X	Y
Bottom of Riser	3,428,767.20	517,193.82
VALVE	3,429,176.55	517,392.51
1	3,429,625.39	517,583.38
2	3,430,911.27	518,126.47
3	3,432,049.99	518,651.64
4	3,433,232.01	519,338.41
5	3,434,417.85	519,872.92
6	3,435,425.77	520,269.78
7	3,436,072.99	520,604.26
8	3,436,744.43	520,911.54
9	3,437,426.32	521,257.28
10	3,437,965.08	521,535.59
11	3,438,568.21	521,781.16
12	3,439,130.99	522,044.65
13	3,439,715.70	522,356.19
14	3,440,341.85	522,630.12
15	3,441,106.43	522,923.89
16	3,442,332.45	523,546.46
17	3,442,648.59	523,683.90
18	3,443,907.59	524,160.86
19	3,445,046.23	524,753.76
20	3,446,315.82	525,391.88
21	3,447,196.55	525,884.79
22	3,447,750.52	526,156.05
23	3,448,371.70	526,469.20
24	3,449,354.74	526,847.22
25	3,450,461.46	527,430.34
26	3,451,538.50	527,831.91
27	3,452,321.87	528,178.43
28	3,453,217.20	528,671.64
29	3,454,004.52	529,086.23
VALVE	3,454,826.64	529,386.70
30	3,455,627.25	529,738.04
31	3,456,153.95	530,001.81
32	3,456,533.49	530,277.05
33	3,457,552.85	530,746.23
34	3,457,946.89	530,956.54
35	3,458,998.87	531,464.02
36	3,459,886.49	531,885.89
37	3,460,267.24	532,028.41
38	3,460,890.78	532,359.60
39	3,461,932.89	533,224.69
40	3,462,199.29	533,556.46
41	3,462,398.24	533,950.29
42	3,462,565.55	534,510.28
43	3,462,663.87	535,201.87
44	3,462,684.19	535,610.65
45	3,462,548.46	536,246.70
12" P/L	3,462,493.30	536,645.14
46	3,462,437.80	536,921.36
47	3,462,166.60	537,433.83
48	3,461,815.50	537,856.84
49	3,461,735.35	538,338.46
50	3,460,801.45	538,594.59
51	3,459,961.49	538,895.14
Bottom of Riser	3,459,418.82	539,163.35

TOTAL FOOTAGE 24" PIPE INSTALLED 44,806.25 FEET = 8.486 MILES FROM BOTTOM RISER IN BLOCK 179 'A' TO BOTTOM RISER IN BLOCK 154 'A'



- NOTES
1. BEARINGS, COORDINATES AND DISTANCES ARE BASED ON STATE PLANE COORDINATE SYSTEM, SOUTH CENTRAL ZONE
 2. THIS MAP REFLECTS THE AS-BUILT COORDINATE LOCATION OF THE ABOVE DEPICTED PIPELINE AS DETERMINED BY ANGLE & DISTANCE (MRS 2011). THE GEOGRAPHIC LOCATION OF THIS PIPELINE IS LANDWARD OF THE TWO HUNDRED (200') FOOT CONTOUR LINE AND WAS INSTALLED TO MINIMUM COVER IN ACCORDANCE WITH DRAWINGS ATTACHED TO TRANSCONTINENTAL GAS PIPE LINE CORPORATION'S APPLICATION APPROVED BY DECISION NUMBER OCS G-4017, DATED MAY 31, 1979.

Reference Drawing Dwg. No.

Transcontinental Gas Pipe Line Corporation Engineering Department
 Houston, Texas
 A Subsidiary of Transco Companies Inc.

**AS-BUILT 24" NATURAL GAS PIPELINE
 HIGH ISLAND AREA
 GULF OF MEXICO**

Drawn By: E. C. Date: 6-2-80 Approved By: [Signature] Date: 6-4-80
 Checked By: [Signature] Date: 6/3/80 Approved By: [Signature] Date: 6-4-80
 A. C. No. 5102.07 Scale: 1" = 4000' Sheet 1 of 1 Dwg. No. DI-B-001